



LOOMIS

REAL ESTATE AUCTION

AMERICA'S AUCTIONEERS



LOW, LOW EXPENSES **MULTI-PURPOSE COMMERCIAL BUILDING** **.42 ACRES**
LIKE-NEW CONDITION
1333 RIDGE AVE., SHARPSVILLE, PA
AKA State Rte. 518
THURS., MAY 30th @ 6:00 PM
 Real Estate @ 6:30



2,500 SQ. FT.
BRICK BLOCK BUILDING
TURN-KEY, GOOD LOCATION!



REAL ESTATE
SUCCESSFULLY SOLD!
\$70,000.00

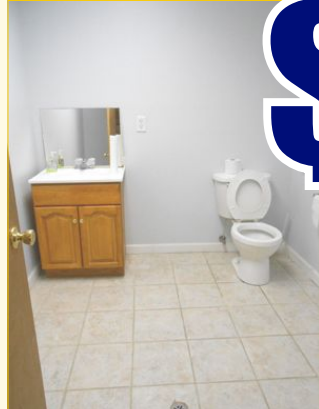

SHOP TOOLS
WOODWORKING MACHINERY
 Complete listing to be advised.
 Woodworking tools and light machinery,
 all name brand and like new.



Terms: 10% down, 10% buyer's premium non-refundable due auction day. Balance at closing. Quick closing by seller. Terms and conditions available online and on auction day.

LOOMIS
 GROUP AUCTIONEERS
 AMERICA'S AUCTIONEERS



25 Executive Ct, P.O. Box 298
 West Middlesex, PA 16159

Trish Loomis: Auction Manager
(724) 962-9145
Rod Loomis: Auctioneer
(724) 528-2550

PA-AU001760
 OH-2009000183

***** Buyers of all categories of inventory!

Like us on Facebook for weekly updates, & info.



Go to loomisauctions.com to view galleries, flyers, and to sign up for email alerts.